

The CAW Newsletter

The CAW Newsletter is the official publication of the Capital Area Woodturners Chapter of the AAW, and is published for the information of its members. Membership in the CAW Chapter is open to anyone interested in the art and craft of woodturning.

Meeting Announcement:

Date: Sat., Nov 4, 2000
Time: 9:30 AM— 3:30 PM
Place: *Millennium Arts Center*
65 "I" Street, SW
Washington, DC 20024

DIRECTIONS TO THE MEETING: From Virginia, take I-395 going East across the Potomac River. 1.5 miles past the river, do not take the I-395 turnoff towards the Capital but continue on towards I-295. At the next exit, take the South Capital Street exit going South. At the bottom of the exit ramp, at the traffic light, turn right onto "I" Street. At the first opportunity, turn right into a driveway and park between the MAC and the health clinic. From Maryland take I-295 across the Anacostia River. Get off at the first exit-12th Street. Turn left onto "M" Street going west. Approximately 1.5 miles down, turn right onto Delaware Ave. At the deadend circle, turn right onto H street and park on "H", the driveway near the clinic, or behind the MAC.

Program For The Month

Please Note!!

*This is an ALL-Day SATURDAY
 Turning Demonstration at our NEW location
 On a different day than usual*

8:30 AM Help set up for the demonstration. Look over the for sale items in the equipment room. Have a cup of coffee with your fellow turners. Enjoy the normal hour of skill enhancement and practice time on the lathes. Or talk over problems and techniques with someone who might already have been there and done that.

We'll See You There!!

9:30 AM A short business meeting during which we will discuss the election of new year's officers and review upcoming events for the remainder of the year. Show-&-Tell tables will be set up, but we will not discuss each piece. Photos of member items will be taken for the December newsletter. The tape library will be open. The day's raffle will be: **a JET Mini-lathe**

10:00 AM David Ellsworth will present one of his renowned demonstrations of tips, tricks, and techniques of woodturning that have been culled from decades of being on the forefront of advances of woodturning art and craft. Mr. Ellsworth has the well-deserved reputation of being an excellent teacher. His demos are filled with practical information that is valuable to every level of turner from the novice to the production professional. He is one of the world's elite master craftsmen in woodturning and you should not miss the opportunity to hear him speak.

12:00 PM Lunch break. Bring your own lunch & drinks or you join others to order pizzas.

12:30 PM - 3:30 PM Complete the demonstration and question & answer session.

Parking at the Millenium Arts Center

The sketch on page 2 shows the parking areas that are available at the MAC. There are metered spots (no fee on weekends) on the 4-lane "I" Street in front of the MAC. There are parking spots in the driveway between the health clinic and the MAC. There are parking spaces on "H" Street behind the MAC and there is parking space in a private lot in the rear of the MAC near the shelter.

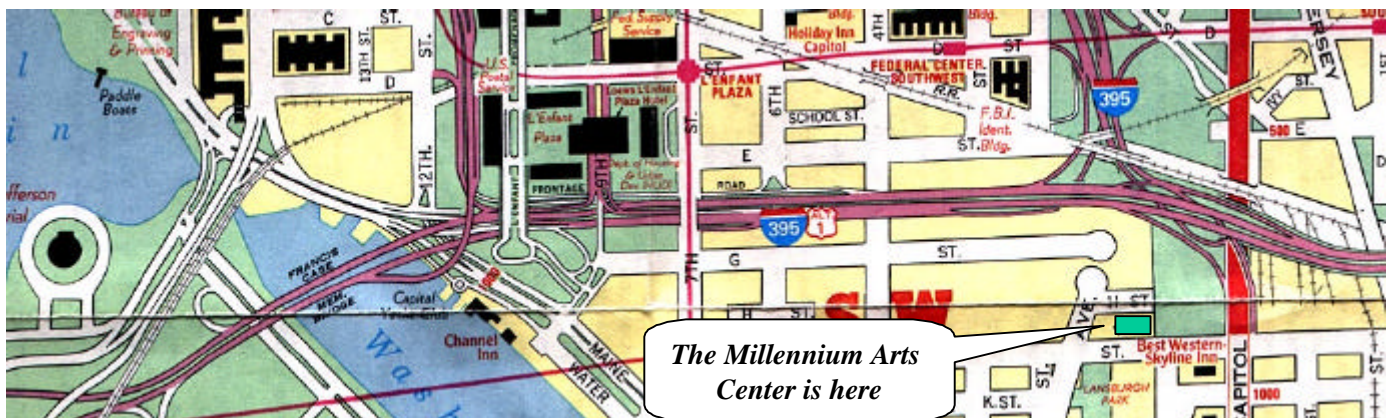

The Millennium Arts Center is here

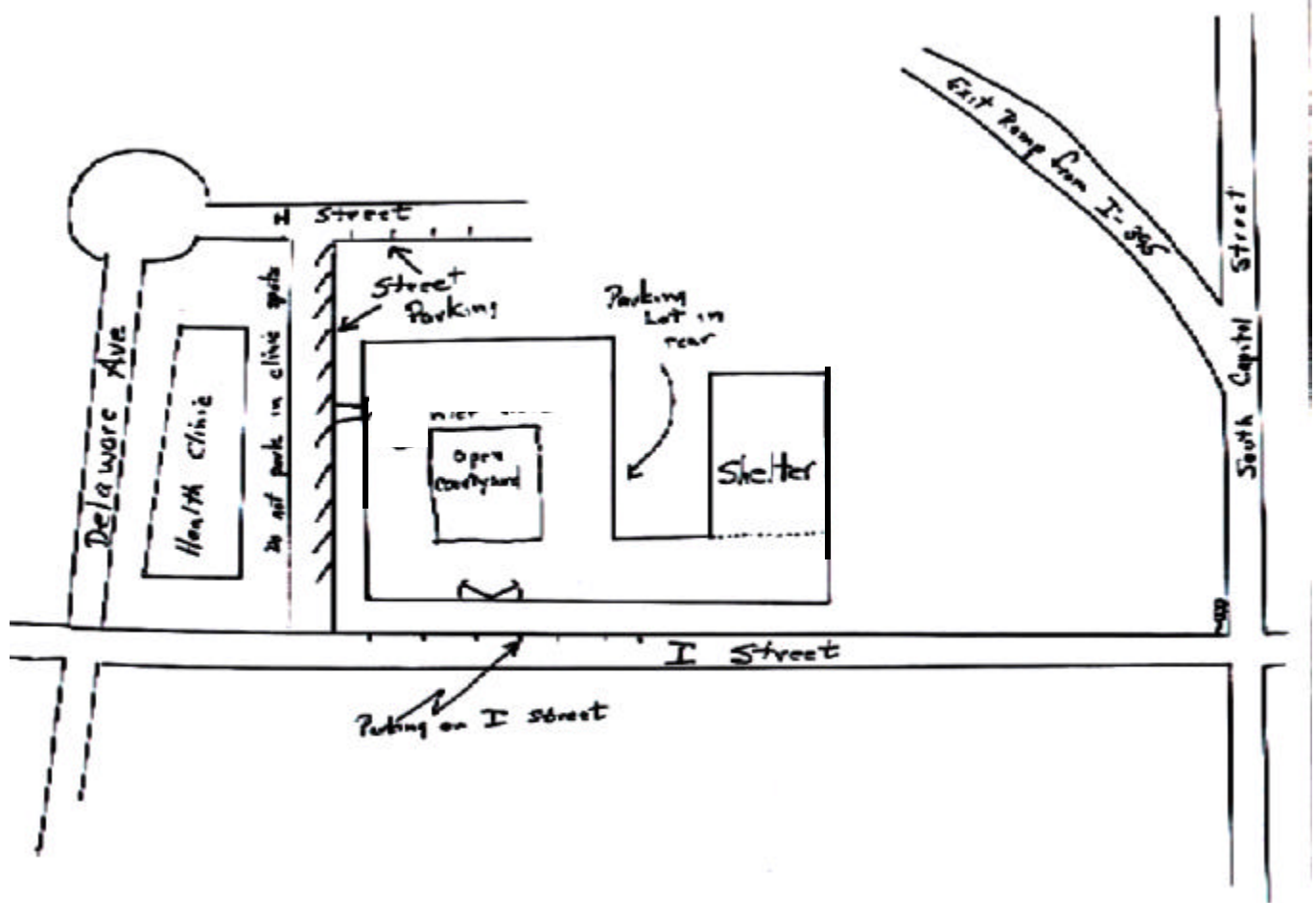

Slate of officers for 2001

In the July 2000 newsletter, we asked each CAW member to think about what he or she might be able to contribute towards making our club a better organization in the year 2001.

In response, Bob Pezold has stepped forward to volunteer to act as our President for the coming year. However, we still need someone to agree to fill the position of the Vice-President and someone else to take over the some of the activities of the monthly raffle and group buys that Dick Krehling has been doing for the last couple of years

If you are interested in volunteering, please contact Jim Marstall, or any CAW officer or director. We will gladly discuss how the club functions and how you could contribute to our objectives. If you are interested in one of the other club positions, (for example, like, say, oh, secretary), please let us know. The present officer may be perfectly willing to move to some other function.

CAW 2000 Officer Roster

<u>Name</u>	<u>Contact Information</u>
Ray Inaba <i>President</i>	2720 Burning Oak Drive Waldorf, MD 20601 301-870-5431 inaba@erols.com
Pat Berry <i>Vice-President</i>	2019 Virginia Ave. McLean, VA 22101 703-534-8746 patberry@erols.com
Mike McInerney <i>Treasurer</i>	14526 Creek Branch Court Centerville, VA 22020 703-378-8117 mikemc1421@aol.com
Jim Marstall <i>Secretary</i>	6213 Capella Ave. Burke, VA 22015 703-644-6797 james.marstall@west.boeing.com
<i>Tim & Sheryl Kochman</i>	10411 Todman Landing Court Burke, VA 22015
Program Directors	
<i>C. A. Savoy</i>	1309 Gatewood Drive Alexandria, VA 22307
<i>Show Director</i>	703-765-7268

Information on the December 10, 2000 CAW Woodturner's Holiday Social

Please clip this page and save it for next month's activities

Christmas is Just 6 Weeks Away !

Please mark your calendar now for **Sunday, December 10, 2000** to reserve that evening for the second annual CAW Woodturners Ball and pot-luck Christmas Social. This was a tremendous success last year. It is a time for all members and their spouses to get together in a strictly social environment. No demos, no business, no wood shavings on the floor. Just friends who share a love of woodturning, eating heaping platefuls of wonderful food, and having some fun together. Some of the ladies brought quilts and other crafts that they had been doing over the year as well. What talented people!

We will have a Holiday Season tree ornament competition with votes cast by all the attendees. Art Jenson, the reigning ornament champion, needs to get a run for his money this year, so start designing your fly-house, tree ornament, ice cycles, and tree toppers now.

There will be a "Grab-Bag" gift exchange, so you should start now working on whatever you want to put into Santa's sack. Those that bring a gift - get to choose a gift. No rules, strictly voluntary. Turn something that you in turn would enjoy getting, and put it into the "Grab bag". It can be signed or unsigned - it is completely up to you. But only those that contribute will get a number for the blind drawing.

Last year, Chris Light collected toy donations for the Toys for Tots Campaign on behalf of the CAW. Bring a new, wrapped toy or book or stuffed animal and Chris will ensure it gets to some needy kids

Directions to the CAW December Social

For everyone's information, following are a couple of maps to help you find the locations of the Sunday, December 10th Christmas social. Please clip this map out and save it somewhere so you can easily find us the night of the party.

We'll probably print the map once again in the December issue, but we want everyone to get an idea of where the church hall is located so you can practice getting there.

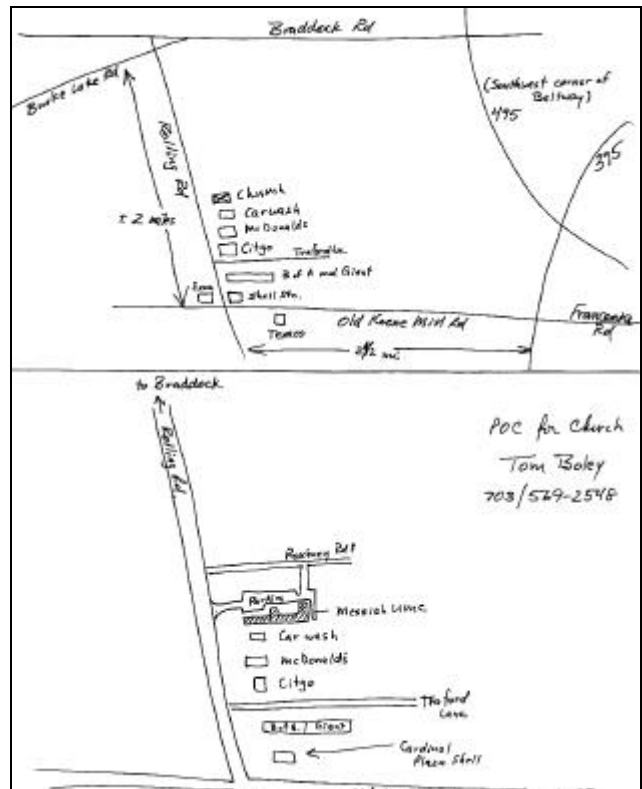

Suggestions For what to bring for the CAW Christmas Social

This is a different distribution from last year's Christmas party and different from the September picnic

- **Soft drinks and coffee will be served** (NO Alcohol please)
- **Bring a dish to share** (Sample dishes)
Last name starts with:
 - **A - G: Main Course** (Lasagna; Ham; Chicken/Turkey)
(Don't let this get too expensive)
 - **H - N: Salad** (Green; 3-bean; Greek; Taco, Jello, etc.)
 - **O - T: Dessert** (Too many mouth-watering options to mention)
 - **U - Z: Side Dish** (Potatoes, Vegetables, Fruit, stuffing)
- **Bring a cheap serving spoon for your dish**
- **Bring your best Holiday carols/dancing music**
- **Bring a toy for the Marines' "Toys For Tots"**

The club will provide:

- Napkins**
- Utensils**
- Plates**

There is a heating oven available, but don't plan on cooking from scratch

Tip of The Month

Setting Proper Lathe Height

by Jerry Fant, AAW Magazine Tips Editor

Turners come in different shapes, sizes and heights. The lathe height as it comes from the manufacturer tends to be in one standard size that may require reaching up or leaning down when you begin using it. These positions will either leave you with a sore back or lacking in tool control.

The proper lathe height should be set so that when your elbow is bent, the bottom will be at the center line between the spindle and the tail stock. I am an average height personal and both of my lathes are on three inch riser boxes filled with sand. Ever since I raised my lathe to this height, there have been no more sore backs from a day turning in the shop.

Video Tape Reviews

Video reviews are provided by the video librarian or anyone else wanting to give a review. For simplicity sake, videos are categorized for their audience, given a rating from zero to five, and summarized on their content.

Two reviews from the Tape Librarian - Gerry Headley

Title: Woodturning, A Foundation Course

Author: Keith Rowley

Tape: CAW# 53

Level: Beginner

Rating: 5 Stars

Description: Excellent video combining lathe operations, chalkboard, and graphics to describe basics in wood turning. Accompanies the book of the same name, but proceeds at a slow enough pace that the book is not necessary. Goes over spindle and faceplate turning and teaches safety techniques even the intermediate and professional wood turner would do well to review.

Except for the occasional face shot of the turner looking at his work, there are excellent shots of the tools making the described cutting techniques. This tape along with professional instruction will serve the beginner as he learns to turn.

Title: An Introduction to Bowl Turning with Rus Hurt

Author: Rus Hurt

Tape: CAW# 61

Level: Intermediate

Rating: 4 Stars

Description: Pure bowl turning using green wood blanks to show natural edge and conventional bowl turning. Initial rough cutting with a chain saw is sloppy as the

turner digs the tip of the saw in the dirt and rock, but proceeds well after that. Rus uses glue blocks with C/A glue to set up his bowls for turning. Excellent use of the tail stock to keep his work stable.

I was surprised by his use of a spindle gouge for most of the shaping with the exception of the deepest part of the bowl. Another interesting technique included his initial set up which allowed shaping of the outside and inside of the bowl without rechucking. This technique required only one change of the bowl to finish the bottom. Good use of video and chalkboard. Very good shots of cutting.

Items For Sale

Delta 20" Scroll Saw, variable speed. \$225

Contact Dick Krehling 703-435-9146 or E-Mail

10" Delta contractors saw with mobile base; side extension table with built-in variable speed router, fold-down extension table (36" X 48"); extra blades, hold downs, and misc. fixtures \$550.00

4" jointer and Dremel 16" scroll saw, mounted on a rolling stand \$100.00

Contact C.A. Savoy at 703-765-7268 for either item.

Items For Free

I have a bunch of wood I would like to get rid of as I can't turn it fast enough. Got some big pieces various species: apple, pear, walnut, maple, cherry, oak and others. Dick Krehling, 703-435-9146

Near dry wood, saved for years for turning and sculpture, in round log form, moderate checking, lengths 18" to 4', 5" to 12" diameter, maple, elm and other species. Also dry firewood and pallets. Location: 703 Northwest Drive, Silver Spring, MD. (Near White Oak, between Columbia Road and New Hampshire Ave.) To check if some is left, call Carol Romanowski at 301-754-1289. From CAW member Bob Romanowski's storage who died this year.



The Holiday ornaments that were entered in last December's Holiday Social. They will be even better and more this year. Start designing your entry NOW!

About Our Members, etc.

by Phil Brown

Steve Bishop is to be congratulated for two pieces juried into the *Challenge VI - Roots: Insights and Inspiration in Contemporary Turned Objects*, an international exhibit to be on display at Ursinus College, Collegeville, PA, September 8 to November 11, 2001. This prestigious exhibition and a companion conference are sponsored by the Wood Turning Center in Philadelphia, PA.

Phil Brown won an "Equal Award Sculpture" together with four other artists for a spalted maple vessel chosen for the October All-Media Membership Show at The Art League gallery in the Torpedo Factory, Alexandria, VA. **George Skorupski** had two pieces accepted in the same show, a natural edge cherry and a tall bleached piece.

Phil Brown will have two pieces in a M-NCPPC juried sculpture exhibition "*of substance*," at Harmony Hall Regional Center, Ft Washington, MD, Nov 17 - Dec 29, 2000.

Together with about 12 other artists, **Bill Hardy** will be at the home of Laura Nichols (a potter) at 438 Riverbend Road in Great Falls, Virginia on December 2 and 3, 2000. This is a big old beautiful country farmhouse and they will have a country kitchen full of goodies for their guests. So, y'all come visit! Bill now has a web site at <www.turnstylesonline.com>.

Jim Marstall and **C. A. Savoy** took the week-long workshop taught by Lyle Jamieson at Maryland Hall in Annapolis, MD, September 18-22nd. It was very informative and interesting with emphasis on the Ellsworth grind, stabilized scraping tools, and laser beam light for thickness control. They will give us a demonstration early next year.

Ed Moore took Ray Key's class at Arrowmont School of Arts and Crafts, Gatlinburg, TN this past summer, apparently the only CAW member to attend a class there this year.

I'm very sad to report that **Bob Romanowski** passed away last February 1st from a heart attack. Bob was not very active in CAW, but he did display his bowls in several Washington Woodworker exhibitions held at Rock Creek Gallery, and worked on the organizing committee by twice obtaining and setting out the food and drink for the opening reception. Bob's lathe and other equipment went to his son-in-law, and we held a wood clean up session on October 22nd.

John Russell had a booth at the Bethesda Row Arts Festival on October 14 - 15, 2001. We haven't seen him because he is doing so many shows (eight this summer), and then rushing home to turnout more product for the next one. He will be at the Hand Workshop in Richmond, November 11-12th; Sarasota, FL, Nov 30-Dec 3rd; and then the ACC show in Charlotte, NC, December 7-10th.

Scott Wallis will setup his table at the Howard County Holiday Mart at Centennial High School over the weekend of December 2-3, 2000.

Promote yourself in the CAW Newsletter by sending information to Phil Brown, 12200 Wynmore Lane, Bowie, MD 20715-1282. Phone: 301-262-8597. E-mail: philfbrown@greenbelt.com

NEWS ITEMS

1. The Chesapeake Woodturners are planning a chapter exhibit at Montpelier Cultural Art Center in March 2001. Their web site is <chesapeakewoodturners.com>, and is managed by Temple Blackwood.
2. Jacques (Jack) Vesery will teach a three day master class at Maryland Hall, Annapolis, MD in March 2001.

Jim Marstall, Secretary
Capital Area Woodturners (CAW)
6213 Capella Ave.
Burke, VA 22015

LOTS of new information inside!! **David Ellsworth is
coming to the CAW on November 4th**

CAW Newsletter — November 2000

New CAW Members for September 2000

Welcome all! We are glad you have chosen to add your talents to our club. We look forward to the contributions you will make, and the pieces you will bring in to Show-&-Tell, to add to our mutual love of woodturning and collective knowledge and skill.

<u>Last Name</u>	<u>First Name</u>	<u>City</u>	<u>ST</u>
Long	John	Bethesda	MD
MacKeen	Susan	Sterling	VA
Kinney	Mike	Alexandria	VA
Moffett	Norm	Lake Ridge	VA

